

FOR SALE

\$ 76,900.00 USD

Honduras - Francisco Morazán

Distrito Central (Comayagüela y Tegucigalpa)

Listing ID: 002913450014

Strategically located between Bulevar Suyapa and El Trapiche, with direct access to the Anillo Periférico, Distrito Artemisa offers a modern and functional infrastructure, ideal for businesses, retail spaces, and healthcare professionals. This innovative complex integrates corporate offices, a medical floor with 55 clinics, and a commercial area, providing a dynamic, efficient, and secure environment.

Corporate Offices – Flexibility and Cutting-Edge Technology
11 office levels per tower Spaces starting from 33.7 m², customizable to your needs Starting at \$76,900 Natural lighting and ventilation for an optimal work environment Six spacious elevators per tower with restricted floor access Smart parking control system Advanced fire alarm system

Medical Floor – Comfort and Functionality for Healthcare Professionals
55 private clinics with natural lighting and ventilation Spaces starting from 32.7 m², adaptable to various specialties Starting at \$76,900 Reception and waiting area for patients Medical directory and common re

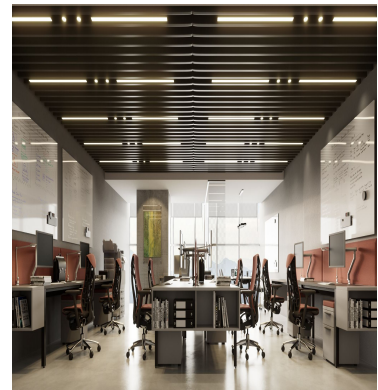
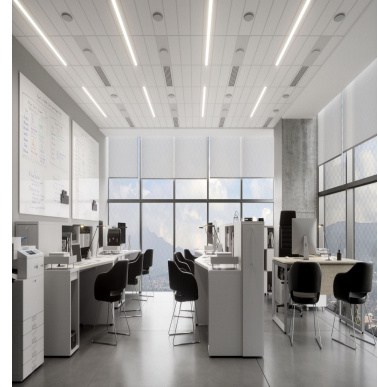

[SEE PROPERTY ON GOOGLE MAPS](#)



SILVIA ROMERO
Sales Agent
504 94991637
sromero@remax-infinite-hn.com
<https://www.remax-infinite-hn.com>



RE/MAX INFINITE GROUP

San Pedro Sula Area, San Pedro Sula Area, Honduras

Each office is independently owned and operated